



## RSC-900 Series Quick-Start Guide

**NEED INSTALLATION OR SETUP ASSISTANCE?**  
**Call toll-free: 888-771-4929**  
**Or visit [www.RelianceDetection.com/support/RSC-900](http://www.RelianceDetection.com/support/RSC-900)**

### RSC-900 Wireless System FCC & Industry Canada Information

This device complies with Part 15 of the FCC Rules. Operation is subject to the following two conditions: (1) this device may not cause harmful interference, and (2) this device must accept any interference received, including interference that may cause undesired operation.

Certifications:	FCC	IC
Flood Sensor RSC-900-W-001	2AFOICLMFLD10	20798-CLMFLD10
Hub RSC-900-X-650	2AFOICLMCTRL10	20798-CLMCTRL10
Hub RSC-900-X-800	2AFOICLMCTRL10	20798-CLMCTRL10
Actuator RSC-900-W-310	2AFOICLMASOU20	20798-CLMASOU20

Communication hub: IP Rating IEC60529

Valve/actuator: IP Rating IEC60529; IP68, ANSI61, Annex G (valve)



**RSC-900 leak detection systems with shut-off valves should be installed by an authorized plumber. Hub and sensors are for interior use only. The valve/actuator may be installed on the exterior of the building, if necessary and as the local climate allows. When considering exterior installation, be sure the actuator would not be immersed in water for more than 30 minutes and immersed in water deeper than 3'. Do not install any components inside a metal cabinet.**

### RSC-900 System Components (included in all kits):

- 1 – Communication hub (Ethernet or Wi-Fi)
- 2 – AA batteries (hub)
- 1 – Ethernet cable (Ethernet models only)
- 1 – 110V plug (hub)
- 2 – Water flood sensors
- 4 – AAA batteries (sensors)

### RSC-900-AW kits:

- 1 – Valve
- 1 – Actuator
- 4 – CR123A (3V) batteries (actuator)
- 1 – Long parallel mounting adaptor (valve/actuator)
- 1 – Short perpendicular mounting adaptor (valve/actuator)
- 1 – Emergency key (valve/actuator)

1

## Download the RSC-900 System Management App

Download the "RSC-900 by RDT" app onto the designated smartphone from the Apple App Store or Google Play.



2

## Set Up the Communication Hub

**FOR WI-FI HUB SYSTEMS:** You will be registering the RSC-900 to your designated Wi-Fi network; confirm that your mobile phone is connected to the same before proceeding. From the phone settings, select the system hub from the list to join it to the network. Follow the prompts on the app to complete system set up. Reference steps 4 – 8 for hardware installation, set-up confirmation and system testing.

### FOR ETHERNET HUB SYSTEMS:



2 - Install batteries

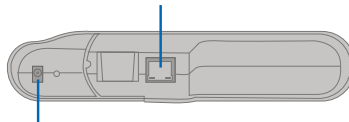

3 - Plug into wall outlet

- A. LED status light
- B. Upper cover
- C. Lower cover
- D. Power / Ethernet inputs (bottom of lower cover)
- E. Table stand (detachable – Ethernet hub only)

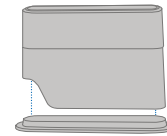
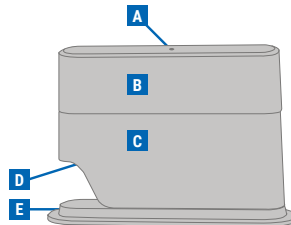

Flat Surface Install

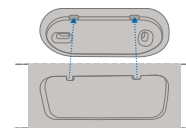

Wall Mount Install  
(screws not included)

**DO NOT** proceed to next step until the LED on top of the Hub is flashing green (Internet communication has been established). Check the Internet firewall settings on your router or consult your Internet provider if you see a blue LED on the Hub.

3

## Set Up Account & System

1 - Once Internet communication has been established with the hub (as indicated by flashing green LED status light) create a New Account and System in the app.



**IMPORTANT!** Visit our website for detailed video instructions for account and system set up:

[www.RelianceDetection.com/support/RSC-900](http://www.RelianceDetection.com/support/RSC-900)

2 - After your account has been set up on the app, scan the Kit Master QR Code found on the outside

of the master kit box (see above) to add the basic kit components to your system. Wait until "Installation Successful" appears on the app and then tap "OK."



## Component Indicator Light Guide

- Green ..... OK
- Blue ..... Communication problem
- Slow Red Flash ..... Low battery
- Quick Red Flash ..... Water leak detected (sensor only)

### Set Up the Valve and Actuator

*(Skip to step 5 if your install does not include water shut-off)*

- 1 - Install the CR123A (3V) batteries with positive side "in" and negative side "out," facing you.
- 2 - Install the stem and adaptor as shown, using the provided screws.
- 3 - Install the valve into the water line after the manual shut-off; after any fire suppression systems; and according to all local plumbing codes.
- 4 - Record the actuator name, location and photo in the app.
- 5 - Turn on the water supply. Check for leaks.
- 6 - Hang the emergency key and tag on the actuator lock (G).

**NOTE: Be sure to turn off the water supply before installation.**

**NOTE: Valves can be installed in any direction or orientation.\***

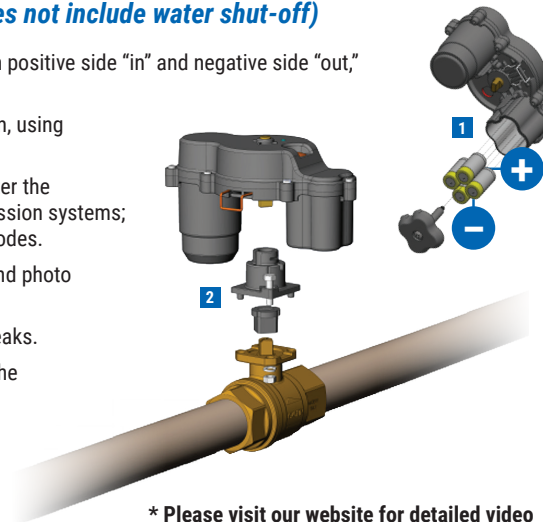

\* Please visit our website for detailed video instructions for hardware component set up:

[www.RelianceDetection.com/support/RSC-900](http://www.RelianceDetection.com/support/RSC-900)

- A. Shut-off valve motor
- B. Motor stem position indicator
- C. LED status light
- D. Multipurpose button
- E. Battery housing cover
- F. Mounting adaptor
- G. Lock
- H. Short mounting adaptor and stem (for actuator install perpendicular to pipe)
- I. Long mounting adaptor and stem (for actuator install parallel to pipe)
- J. Emergency turn key
- K. Valve

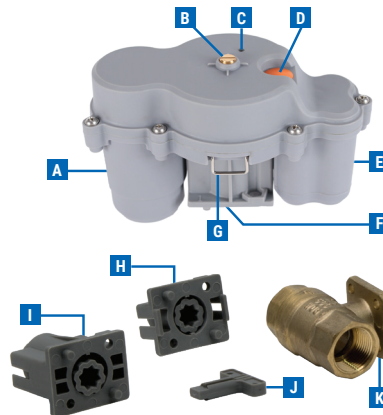

### Manual/Emergency Operation

For information on how to manually open and close the valve, please refer to the included tag.

**NEED INSTALLATION OR SETUP ASSISTANCE?**

**Call toll-free: 888-771-4929**

**Or visit [www.RelianceDetection.com/support/RSC-900](http://www.RelianceDetection.com/support/RSC-900)**

## 5

### Set Up the Master Kit Water Flood Sensors

- 1 - Install AAA batteries.
- 2 - Record the sensor name and location in the app (confirm the correct device via the unique serial number on the app and sensor QR code).
- 3 - Repeat for each sensor.
- 4 - Place the sensors in their desired locations.

- A. LED status light      C. Battery housing cover  
B. Water detection electrodes      D. Double-sided tape

..... Slide to open

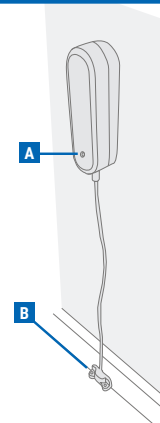
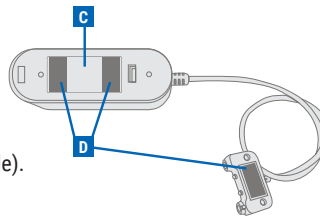

## 6

### Adding Accessory Sensors & Actuators

- 1 - Install the new device in its permanent location.
- 2 - From the App, tap on Menu – Settings – Add/Remove Devices – Configure – Add Devices. Scan the device QR code (see right).
- 3 - Tap the new device on the app screen.
- 4 - Scroll down and tap “Edit.”
- 5 - Add name, location, and photo of installation location (optional).



## 7

### Confirm Set Up

Once all devices have been deployed, confirm your system is properly set up and devices are within wireless signal range of the Hub.



- 1 - From the RSC-900 app menu in the upper-left corner of the screen (see icon at right), click on “Settings.”
- 2 - Tap “Add/Remove Devices.”
- 3 - Tap “Configure” next to the appropriate system (if you have multiple systems).
- 4 - Tap “Accept” at the bottom of the screen. The system will now confirm wireless signal strength of all devices. Devices will be momentarily greyed out on the screen while this occurs.
- 5 - Observe the devices come back on-line (borders around all device icons), along with their “Wireless Signal” strength indication.
- 6 - Look for any warning symbols along the right-hand side of the screen. ⚠ indicates that the use of a repeater is needed for indicated device(s). Follow installation instructions for RSC-900-X-200 Wireless Signal Repeater to overcome wireless signal issues.

## 8

### Test the System

- 1 - Apply a wet paper towel to a sensor's electrodes until its LED flashes red and its alarm/ beep sounds.
- 2 - A “Leak!” indicator message will appear on the home screen of the app.
- 3 - If you have a valve and actuator shut-off installed, confirm that there is no water flow.  
  
In the app, tap the water shut-off icon, and then tap “Open” on the screen to open the valve. Verify that water is flowing at the faucet.
- 5 - Repeat for each sensor in the system.



**Reliance Detection Technologies, LLC**  
27 Business Park Drive  
Branford, CT 06405

203-488-2684 or 888-771-4929  
info@RelianceDetection.com  
[www.RelianceDetection.com](http://www.RelianceDetection.com)

© Copyright 2021 Reliance Detection Technologies, LLC – A Madison Company – All specifications subject to change without notice.

ECN # 12003, 01/2021, MF165, REV F